



2024

PRINCESS F65

I LAGER • F65020 • GBPYYW2012A424

VISNING COPENHAGEN, DENMARK

2X MAN V8 (2X 1300HP) - H
TOPPFART, CA KN
LÄNGD 20.3 M X BREDD 5.1 M
5 KABINER • 4 WC

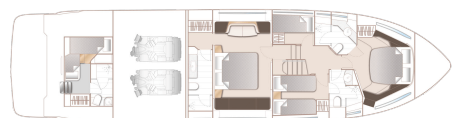
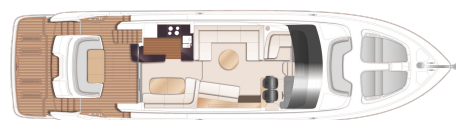
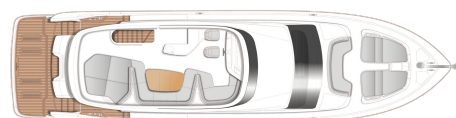

Princess Yachts West Sweden
+46 (0) 304 390 90
princessyachts.se

Princess Yachts Norway
+47 66 76 08 70
princessyachts.no

Princess Yachts Denmark
+45 70 26 84 84
princessyachts.dk

FRAMDRIVNING

Motorer	2x MAN V8
Motor	2x 1300 hp
Typ	Inboard
Drivtyp	Shaft
Bränsle	diesel

DIMENSIONER

Längd	20.3 m
Bredd	5.1 m
Djup, ca	1.63 m
Weight, ca	40177 kg
Bränsle	2x 4100 L
Vatten	873 L
Septik	1x272 L

ÖVRIGT

Tillverkare	Princess Yachts Limited
Designer	Olesinski
Båtkategori	Power
Skrovtyp	Planing
Material	Fibreglass
Elsystem	24 V
Kabiner	5
WC	4

Vi har en ny Princess F65 klar för leverans i Köpehamn.

MOTORER & DRIVLINA

2x MAN V8-1300 (2 x 1300hk)

Variabel bogpropeller och variabel häckpropeller och hold-funktionalitet. (Uppgradering av standard bogpropeller till 210 KgF och en 170 KgF häckpropeller monteras)

upgrade thrusters to new Evison

Tredje styrplats i sittbrunn (motorreglage, nödstopp, bog/häckpropellerkontroll)

STABILISERING

Sleipner Vector Fin stabilisation system with VF800 fins. When underway fins are driven by an engine powered hydraulic motor and at zero speed by a generator powered electric motor (19Kw generator also recommended)

SKROVFÄRG

Vitt skrov (med mörkgrå vattenlinje och svart bottenfärg, vit avbärarlist på skrov och badplattform, rostfritt inlägg)

Radar arch injill panel and canopy stripe finished in graphite grey metallic paint, engine air vent cover and aft end saloon window in onyx black, Exterior furniture in finished in oyster grey meta/lie paint, where specified. Canopy styling blade is white gel coat as standard.

"Canopy graphic to canopy styling blade (note white gelcoat finish as standard) please choose one from selection below

? Electric Blue"

INTERIÖR

Valnötsinteriör, mattlackerad (durken i pentry och fotstöd förarplats är i valnöt som standard)

"Timber flooring to aft dining area (as per galley) in V-groove planked walnut"

Standard helm console is Oyster Grey with helm seats in Quartz III Putty leather

LAYOUT

"Aft Cabin Fit out (B)

with twin bunks (two staggered single berths, wardrobes with shelves, separate toilet & shower). Furniture in specified choice of boat timber with fitted carpet. Includes transom glazing"

Starboard cabin inboard berth to have electrically powered sliding mechanism to convert to double berth

Pull out table to companion L-shape seating area adjacent to helm

STYLING

Elevate the overall styling and ambiance of your yacht with design elements selected exclusively from the Design Studio Collection:

"Allure Collection (excl hardtop):

Interior styling includes:

Quilting detail with contrast accents and rear timber panel (to match boat timber) to main helm seats

Exterior styling includes:

Quilting detail with contrast accents to flybridge helm seating

-Teak step nosing upgrade (including transom, flybridge, foredeck and steps to side deck when side deck option is selected)

-Exterior lighting upgrade package (includes additional deck level lights on side decks and transom, flybridge deck wet-bar & bathing platform)

-Cockpit servery finished in Oyster Grey metallic

-Flybridge console finished in Oyster Grey metallic

-Flybridge wet-bar finished in Oyster Grey metallic

-Exterior upholstery in Comfort Exterior III Met Ice with Met Macadamia contrast detailing

-Underwater transom lights (4 Lumishore SMX53 Blue/White)

-Underwater lighting to aft hull sides (2 per side Lumishore SMX53 Blue/White)

-Pininfarina/Isotta steering wheel at both helm stations

-Princess Crown logo in bathing platform teak"

PENTRY

Pentrybänk och sittbrunnsbar i Sylmar Solid Surface vit som standard för att matcha barbänken

BADRUM

Bathroom worktops are in White Solid Surface (satin finish) with thermoformed wash basins with Solid Surface Carrara White (satin finish) floors

Cabinets in specified choice of boat timber with chrome bathroom hardware as standard
Golvvärme i WC

FÄRGSÄTTNING

Textilier från Quartz VII eller Milan IX är standard

Putty leather in dining sofa and passenger sofa

Premium Carpet London Elements Symphony Paris

Saloon sofa/Master stateroom sofa/Bedheads: Fugace 4217 02 14

Bedcovers: Arizona E252 38 27

"Scatter cushions:

4x Fugace 4213 02 14 50x50cm

4x Burlington String 50x50cm

6x Burlington Tan 50x50cm"

Additional charge for quilted blankets and linen

Lös löpare (matta) i dinette och saloon gangway (200282)

DÄCKSUTRUSTNING

Elhydraulisk sänkbar badplattform (550kg SWL) med gummibåtssystem
GRP flybridge hardtop med belysning, dimmer och el öppning med kapelltak
Elektrisk markis akter om hardtop
Teak decking to cockpit and bathing platform, fitted as standard
Teak på flybridge 6mm
Teak på skarndäck och fördäck 6mm
Fast monterat teakbord på fördäck
Landgång (4m teleskåpisk boxmodell) med automatiskt handräcke
Elektiska vinchar på akterdäck (2)
Sidodörrar i skrovsidan vid sittbrunn
Stainless steel Epsilon anchor (40kg), with stainless steel swivel in place of standard
Additional 20m of 10mm anchor chain to give a total of 80 metres
Stainless steel keyway plates for later fitting of tender slider system on bathing platform
Räkneverk på kätting till ankarspel förut monterad på styrplats

GENERATOR

Whisper M-SQ PRO 22.5kW generator

ELEKTRISK UTRUSTNING

Kontinentala 220V/240V uttag (Skandinavien)
Diskmaskin i pentryt (slim line 9 personers)
Ismaskin i salongen
Handdukstork
"Interior lighting upgrade package
Concealed LED strip lighting to starboard and port sofa base surround"
Raymarine Rear facing day and night network dome marine camera to be displayed on helm MFD screens.
Raymarine camera in engine room to be displayed on helm MFD screens.
(107566) Fit additional batteries (4)
(107619) Supply and fit inverter for galley sockets (for small Nespresso coffee machine) and TVs (only to be ordered in conjunction with additional batteries)
Landströmskabel inkl adapter

UNDERHÅLLNING

"STANDARD AUDIO/VIDEO SYSTEM

Deck Saloon – 55?" LED TV on power lift mechanism with Fusion Apollo MS-RA770 AM/FM/Bluetooth/DAB/WIFI with external USB, Paired with Focal speakers (2)
Owners Stateroom – 43?" LED TV. Fusion Apollo MS-RA770 AM/FM/Bluetooth/DAB/WIFI with external USB. Paired with Focal speakers (2)
Flybridge – Fusion Apollo SRX-400 Radio/Wi-Fi/Bluetooth with waterproof Fusion speakers (2)
Includes 2 x Fusion ARX-70 wireless remotes in black (supplied loose for later fitting)"
Forward Cabin TV & Audio Package – 43" LED TV with Fusion Apollo MS-RA670 with DAB and external USB. Paired with Focal speakers (2)
Upgraded fwd stereo to RA770
Cockpit Audio Package Fusion ERX400 remote control with Waterproof Fusion speakers (2) linked to saloon audio system

NAVIGATION

"Standard navigation equipment incorporates:

Lower helm:

Raymarine Axiom XL 16 (15.6") multifunction colour display, incorporating GPS/chart plotter, log and echo sounder. Raymarine Evolution autopilot with P70Rs control head also fitted. In addition, engine instrumentation (including fuel levels and fuel flow) is displayed on a 9" multifunction display.

Upper helm:

Raymarine Axiom XL 16 (15.6") multifunction colour display, incorporating GPS/chart plotter, log and echo sounder. Raymarine Evolution autopilot with P70Rs control head also fitted. In addition, engine instrumentation (including fuel levels and fuel flow) is displayed on a 9" multifunction display."

Second Raymarine Axiom XL16 (15.6?) colour multifunction display at upper helm

Second Raymarine Axiom XL16 (15.6?) colour multifunction display at lower helm

Raymarine Cyclone HD colour radar, 4kW pedestal with 48? open array scanner

Raymarine AIS 700 Class B transponder interfaced with chartplotter

Raymarine Ray 90 Dual Station VHF

(107620) Remote for autopilot

Sjökort Navionics XG45

KLIMATANLÄGGNING / VÄRME / DEFROSTER

"Reverse Cycle Airconditioning/heating (104,000 BTU) suitable for temperatures to 40°C (tropical) With controls in all cabins and outlets in all areas (including bathrooms)

Recommended generator : 19 Kw"

Aft cabin airconditioning Condensing unit 8,000 BTU supplying 8,000 BTU unit (with SMX control)

Defrostersystem på frontrutor med luft uppvärmd via varmvattensystemet

MYGGNÄT

Myggnät för alla skrovfönster

SEPTIKTANK / TOALETTER

Elektrisk tömning av septiktank

TEXTILIER EXTERIÖRT

Cockpit, Fördäck & Flybridge dynor inkl förarstolar – Comfort Exterior III Vogue

Eucalyptys med Vouge Earth kontrast

Foredeck sunbeds to have manually adjustable head rests and back rests (to provide aft facing seating to complement U-shaped seating area) , in lieu of standard, fixed sunbeds

Vattenavstötande skum i alla standarddynor exteriört i sittbrunn, fördäck och på flybridge istället för standard

Grå kapellduk

(200135) Supply separate grey cover for optional foredeck table

(200136) Supply separate grey cover for cockpit sofa

TILLBEHÖR

8 personers servis med porslin, glas och bestick är standard

Informationen om denna båt är given i god tro och antages vara korrekt, men kan inte garanteras. En köpare, eller dennes besiktningsman, bör undersöka sådana detaljer och skick som köparen önskar validerade. Vi reserverar oss för ändringar eller att båten

upphör vara till salu.



Princess Yachts West Sweden
+46 (0) 304 390 90
princessyachts.se

Princess Yachts Norway
+47 66 76 08 70
princessyachts.no

Princess Yachts Denmark
+45 70 26 84 84
princessyachts.dk