

Princess 52

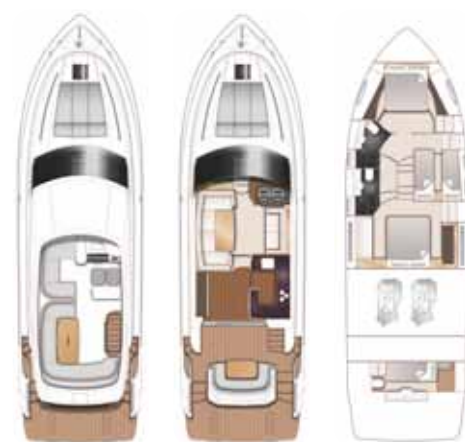

Engines	2 x Volvo Penta D11 (725 hk) ~243h
Year model	2015
Yard no/HIN	P52068/GB-PYIR2068D515
Price	8.995.000 SEK inkl moms
Location	Vindon, Sweden
L.O.A. x Beam x Depth	16,66 x 4,75 x 1,25 m
Fuel capacity	2400 L
Water capacity	536 L + 73 L varmvatten
Holdingtank	182 L
Cabins / Berths / WC	4 / 7 / 3



DRIVE SYSTEM

Variable bow and stronger stern thruster with hold function and remote control
 Trim tabs
 Demist
 Wind screen wipers with flush
 Searchlight

Wetbar on flybridge with grill and sink
 Cool box on flybridge
 Cockpit cover (full version), white
 Separate covers flybridge, white
 Front window cover, black net
 Deck flush with hose
 Drop nose pulpit

TV in owners' cabin with Fusion stereo
 Raymarine satellite TV antenna
 Top bedmattresses on doublebeds
 El flush on WC
 Heated towel rail
 Heated floor in both WC
 Crew cabin with bed and WC

NAVIGATION SYSTEM

2x Raymarine e125 plotter/radar
 4kW open radar antenna
 2x Raymarine p70R autopilot
 2x Raym. i70 log/echo sounder
 2x Raymarine 260 VHF
 Stern camera
 2x Magnet compass

INTERIOR

Interior in satin walnut
 Walnut floor in saloon and stair case down to living space
 Galley top, dark, with special top in glas design by Fendi
 El. saloon table to be used for dining or coffee table
 Princess china
 Icemaker
 El stove with extractor
 Micro/grill/combination oven
 Dishwasher
 Washing machine/dryer
 40 inch TV on elevator
 Fusion stereo in saloon

OTHER

Shorepower/Charger
 ONAN generator 7kW
 Watermaker
 LED lights
 Continental 220V sockets
 Calorifier
 Heater Eberpächer in-doors
 Separate cockpit heater (new-17)
 Holdingtank with ocean/deck emptying
 Mooring equipment
 BRIG Eagle 340 tender with Evinrude 30hp outboard and Raymarine plotter

EXTERIOR

White hull
 Teak in cockpit, bathing platform, side decks and flybridge
 Hydraulic platform
 El bow windlass, 60m chain and stainless steel anchor and meter

The equipment list is believed to be accurate, but we reserve the right for errors and the boat will be sold with the equipment fitted.