

Storebro 355 Baltic

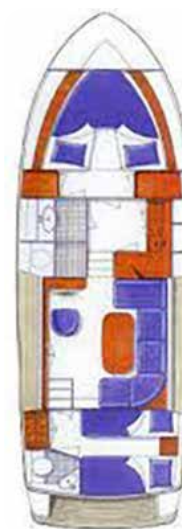

Engines	2x Volvo Penta TAMD 63P (355 hp) ~950 h
Yard no. / Engine no.	3710 / 2061099631, 2061099632
Year model	1995
Price	995.000 SEK inc EU VAT
Location	Germany until spring 2019
L.O.A. x Beam x Depth	10.76 x 3.75 x 1 m
Weight	7,6 ton
Fuel capacity, ca	2x 500 L
Water capacity, ca	400 L
Holding tank, ca	Yes
Cabins/Berths/WC	2 / 4+2 / 2



NAVIGATION & MANOUVERING

Bow thruster
 2x Simrad CA40 plotter/radar 10 inch display (newer)
 2x Simrad AP20 autopilot
 2x Log
 2x Depth
 2x VHF
 Compass
 Searchlight
 Trim tabs
 Horn

EXTERIOR

Complete teak deck
 Openable pulpit/bow ladder
 El windlass bow
 El windlass aft
 Stereo with speakers on flybridge
 TV-antenna
 Tender out board bracket
 Snap-on-davits tender fittings
 Bathing ladder

Fender holders on stern
 Navigation lights
 Cover for chairs and instruments on flybridge

INTERIOR

Corian galley top
 Double stainless steel sink
 Fridge
 Gas stove
 Extractor above stove
 El oven/micro
 Storebro china
 Stereo with speakers
 Top bed mattresses

OTHER

Mooring equipment
 Shore power and charger with battery monitor
 ONAN generator
 Diesel heater
 Calorifier (hot water)
 Holding tank with el discharge in sea and deck discharge

The equipment list is believed to be accurate, but we reserve the right for errors.